



REPUBLIC OF LATVIA

Tel: +371 67300664
 Fax: +371 67300660
 Email: ais@lgs.lv
 AFS: EVRAYNYX
 URL: https://ais.lgs.lv

State Joint-stock Company
 "Latvijas gaisa satiksme"
 Aeronautical
 Information Service.
 Muzeju iela 3
 Lidosta "Rīga"
 Mārupes pag., Mārupes nov.
 LV-1053, Latvija

AIP SUP 013/2026
Effective from 24 APR 2026
to 31 JUL 2026
Published on 24 APR 2026

RIGA AERODROME (EVRA) - MOBILE CRANES OPERATING IN THE VICINITY OF THE AERODROME

Replaces AIRAC AIP SUP 003/2026

1. General

From 24 APR 2026 until 31 JUL 2026, daily from 0430-1730 (0330-1630) UTC mobile cranes are operating in the vicinity of the aerodrome due to the construction of a new ATC tower. The cranes penetrate the Aerodrome Obstacle Limitation Surfaces.

The mobile cranes are operating in the area with coordinates:

565528.3N 0235847.7E - 565528.3N 0235851.9E -

565525.3N 0235851.7E - 565525.5N 0235846.6E -

565527.6N 0235847.0E - 565528.0N 0235847.6E -

565528.3N 0235847.7E

Distance: 520 M from ARP and direction 84°.

Maximum elevation: 243 FT (74 M) AMSL, 210 FT (64 M) AGL.

The cranes are equipped with type A medium intensity white flashing light.

See Appendix 1.

2. Impact on Obstacle Clearance Altitudes (Height) (OCA (H))

During mobile crane operations, the OCA (H) values are increased for the following instrument approach procedures:

RNP Y RWY18 (Ref: AIP EVRA AD 2.24.13-5)

OCA (H)	A	B	C	D
LNAV/VNAV	293 (260)	305 (272)	325 (292)	352 (319)

RNP Z RWY18 (AR) (Ref: AIP EVRA AD 2.24.13-7)

OCA (H)	A	B	C	D
---------	---	---	---	---

RNP 0.3	374 (341)	386 (353)	394 (361)	405 (372)
---------	-----------	-----------	-----------	-----------

RNP Z RWY36 (AR) (Ref: AIP EVRA AD 2.24.13-17)

OCA (H)	A	B	C	D
RNP 0.3	373 (336)	385 (348)	393 (356)	404 (367)

3. Impact on ILS LOC classification

During mobile crane operations, the ILS LOC RWY18 classification is changed to II/T/3 (Ref: AIP EVRA AD 2.19; AIP GEN 3.4).

4. Additional information

1. The new ATC tower is included as an obstacle in the Obstacle Data Set effective 19 MAR 2026 (UUID: 3bf43c8f-3221-4af7-83f6-e45b18e3c9ff).
2. A NOTAM will be issued to inform users of the mobile crane operation schedule and any changes to it.

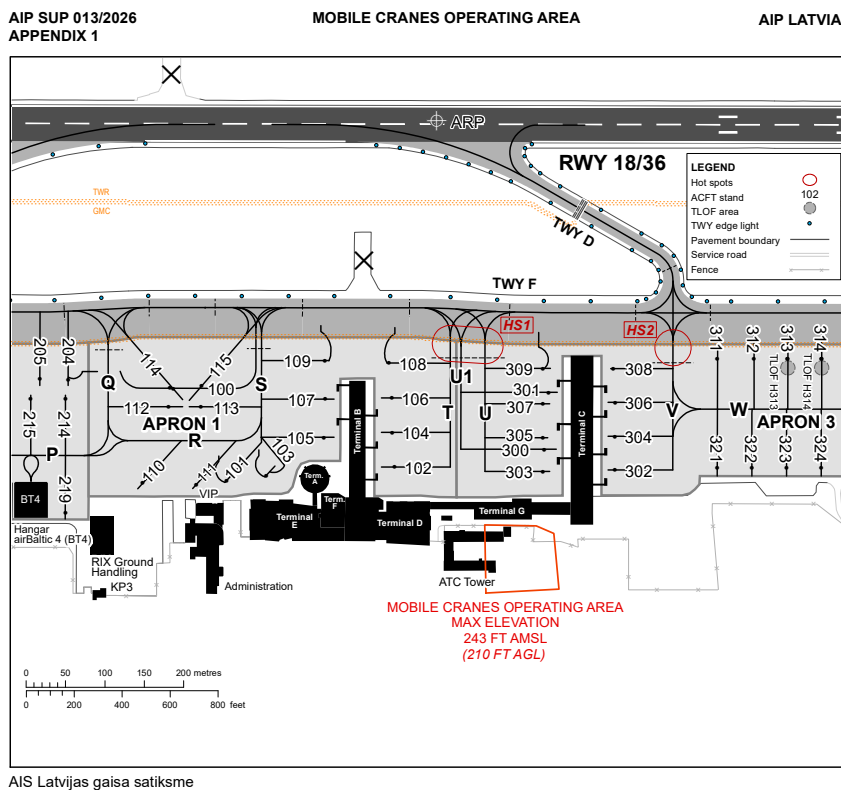

AIS Latvijas gaisa satiksme